



1

Before Starting Assembly, please check contents are as follows:

- 1 White Felt Bag Filter with black tube
- 1 Carbon Filter
- 1 Test Bottle
- 1 Cleaner Tower (120, 360, 900 or 1250)
- 1 Drilled Lid

Service interval kit comprising:

- moulded plastic mount + screw
- printed card
- self-adhesive Timestrip.

Fitting kit containing:

- 1 Straight adaptor 15mm x 1/2" BSP
- 1 Blanking Plug - large
- 1 Elbow 15mm
- 1 Assembled Porting Block
- 3 Porting Block Small Blanking Plugs
- 4 Screw 4.8x45mm and washers
- 2 Grab Taps
- 1 Blue nylon adaptor
- 1 Black Tube:

| | |
|----------------|---------|
| SEP120 | = 73mm |
| SEP360 | = 100mm |
| SEP900 | = 180mm |
| SEP1250 | = 200mm |

Service Indicator - assembly and attachment



i Insert the boss on the reverse of the mount **(c)** into the pre-drilled hole in the separator lid.

ii Peel backing from timestrip **(a)** and attach to the plastic card **(b)** within the dotted lines.

iii Flex the card, passing the ends through the slots on the top surface of the mount.

To activate, press firmly on the timestrip label at the point indicated.

After a few minutes a red line will appear, to indicate 'time in service' up to 12 months

A replacement card and timestrip will be supplied with each service kit.

General Installation notes

- Please ensure a steady fall in the pipe run from the outlet point to the foul drain.
- Never discharge condensate to a storm drain or to surface water; always connect to a foul drain or sewer.
- Remember that it's the user's responsibility to check with the local authority as to the permissible discharges in their area.

Testing Quality

Replace filters before outlet cloudiness exceeds the ppm limit for your region.

Test outlet quality weekly using kit provided.



Further information is available on our website below.



Fit the inlet block to your chosen side using the screws provided. (Extra blocks can be purchased if required.)



Insert the large blanking plug into the remaining unused port block located on the opposite side of the unit.

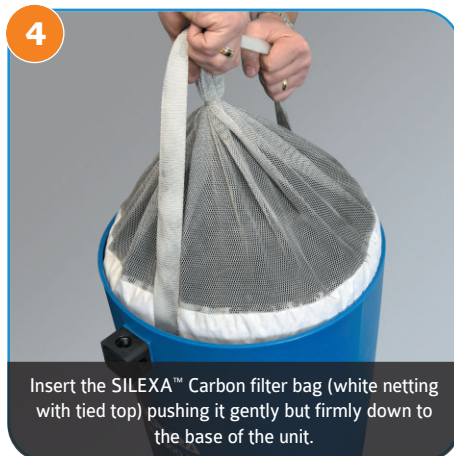

Insert the SILEXA™ Carbon filter bag (white netting with tied top) pushing it gently but firmly down to the base of the unit.

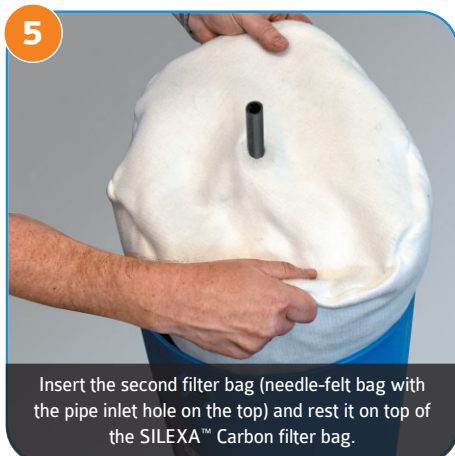

Insert the second filter bag (needle-felt bag with the pipe inlet hole on the top) and rest it on top of the SILEXA™ Carbon filter bag.



Screw the inlet connector (Reducing Bush) into place tightly.



Connect the filter tube to the inlet block using the fittings supplied.



Attach the twist off Grab Tap to the test point. Attach your outlet hose to the nipple above. Fill unit with water and check for leaks.

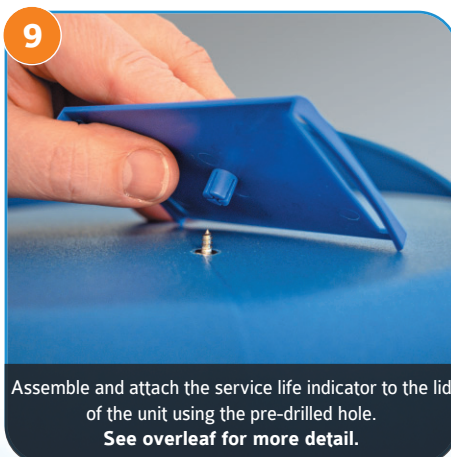

Assemble and attach the service life indicator to the lid of the unit using the pre-drilled hole. See overleaf for more detail.



For SEP 120 D and SEP 360 D consider using our Wall Mounted Bracket. See our website for details.

Completed
SEP 120 D
SEP 360 D
SEP 900 D
SEP 1250 D
Units



For information on the correct positioning and installation of your Sepura Separator Unit please see the accompanying leaflet.



t: +44 (0)1543 379212

e: sales@sepura-technologies.com

www.sepura-technologies.com



The mark of responsible forestry